

## Royde & Tucker H102-A HI-LOAD projection butt hinge

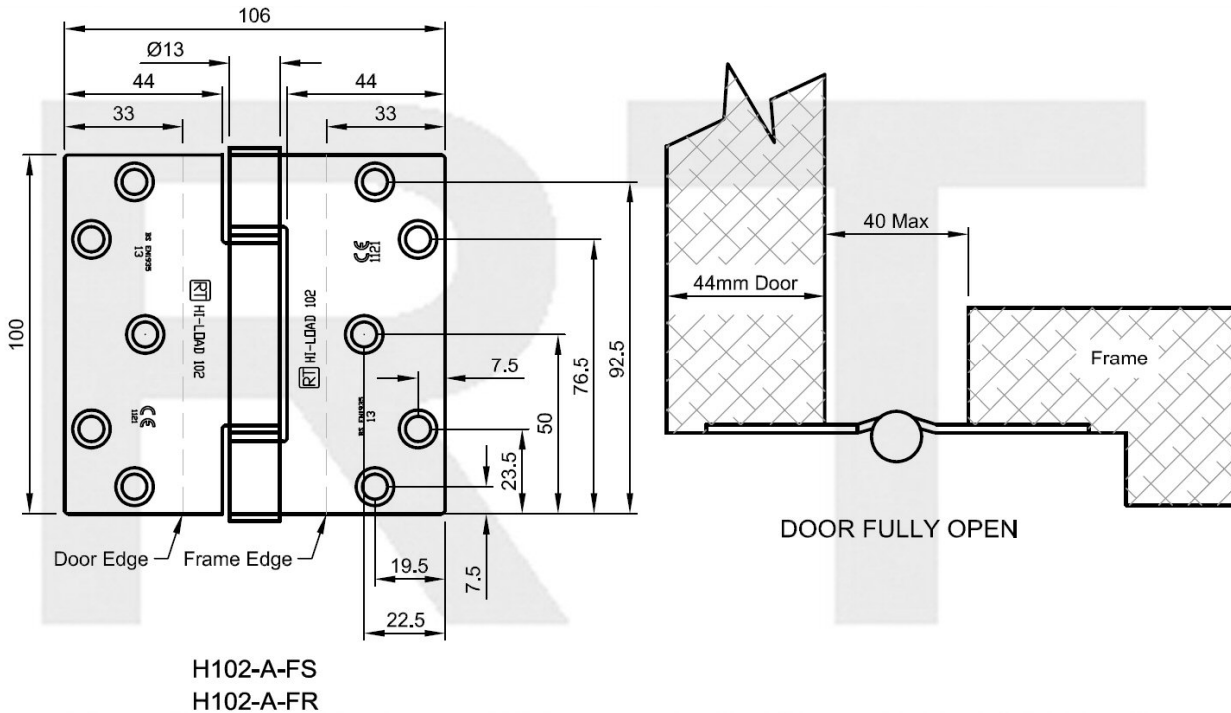

BS EN 1935



- Allows the door leaf to pivot around obstructions such as architrave. 20mm projection (106mm overall width).
- 100x106x3mm Three knuckle projection hinge
- Maximum adjusted door weight 100kg
- To BS EN 1935 Grade 13
- Minimum door thickness 44mm
- Maintenance free, guaranteed for 25 years
- CE Certificate No. 2812-CPR-AC0063
- Suitable for use on fire doors: Certifire approved – CF209
- To be fitted with HP102 intumescent hinge pads, if being installed on fire doors
- c/w metric 5 x 32mm wood screws
- Unless stated Mild steel substrate, Grade 304 or 316 stainless steel available

**Royde & Tucker Ltd**  
 Bilton Road  
 Cadwell lane  
 Hitchin  
 SG4 0SB

Tel: 01462 444444

Fax: 01462 444433

www.ratman.co.uk

e-mail: sales@ratman.co.uk